

data sheet

ARGCO



Email: Jared@Argco.com

Carriage with Lever

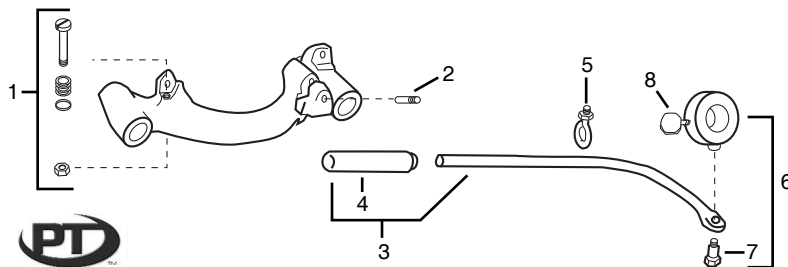

REF	PART #	DESCRIPTION	RIDGE #
-	33-02-100	Carriage with lever	68815
-	33-02-100A	Carriage Lever kit (incl. 3, 5, 6, 8)	42385
1	33-02-101	Carriage stop bolt assembly	45515
2	33-02-103	Carriage reamer hinge pin	47065
3	33-02-104	Carriage lever arm assembly	43400
4	33-02-105	Carriage handgrip	46235
5	33-02-106	Carriage eye bolt assembly	46205
6	33-02-107	Carriage collar assembly	46215
7	33-02-108	Carriage shoulder bolt	46210
8	33-02-114	Carriage thumbscrew	46220
	33-01-100	Carriage Assembly Complete	

RIDGID® is a trademark of RIDGID, Inc. The trade dress of the RIDGID® Model 300 Power Drive product is a trademark of RIDGID, Inc. ARGCO is not an authorized distributor of RIDGID® products.

The information contained herein is produced in good faith and is believed to be reliable but is for guidance only. ARGCO and its agents cannot assume liability or responsibility for results obtained in the use of its product by persons whose methods are outside or beyond our control. It is the user's responsibility to determine the suitability of any of the products, methods of use, or preparation prior to use, mentioned in our literature. It is the user's responsibility to observe and adapt such precautions as may be advisable for the protection of personnel and property in the handling and use of any of our products.